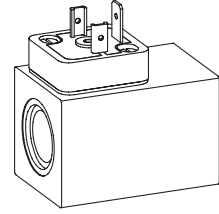

**Solenoid coil M.35/16  
 to VDE 0580  
 Protection class IP65/IP67**

**DESCRIPTION**

The slip-on solenoid coil M.35/16 is available with different types of electric connections (see type code). The construction corresponds to standard VDE 0580. The steel housing is zinc coated for high corrosion protection.

**FUNCTION**

In combination with the corresponding armature tube the function of an on-off solenoid or proportional solenoid will be obtained. The AC voltage type incorporates a rectifier. The available AC voltages are listed in the type code section.

**APPLICATION**

Due to its robust design the coil is mainly intended for hydraulic applications.

**Caution:** To avoid overheating the coil may only be energised when mounted on an armature tube and valve.

**CONTENT**

SPECIFICATIONS ..... 1  
 TYPE LISTE / DIMENSIONS ..... 2/3  
 SAFE OPERATION ..... 3

**TYPE CODE**

M  35 / 16 -  -  #

Steel coil  
 Mobile type

*Electric connection:*

Connector socket ISO 4400 / DIN 43650	<input type="checkbox"/> D
Connector socket AMP Junior-Timer	<input type="checkbox"/> J
Flying leads execution (length 500 mm)	<input type="checkbox"/> L
Cable execution (length 1500 mm)	<input type="checkbox"/> K
Bayonet connector	<input type="checkbox"/> B

Coil types

Tube hole diameter 16 mm

*Standard-nominal voltage  $U_N$ :*

12 VDC	<input type="checkbox"/> G12
24 VDC	<input type="checkbox"/> G24
110 VAC	<input type="checkbox"/> R110 *
115 VAC	<input type="checkbox"/> R115 *
230 VAC	<input type="checkbox"/> R230 *

\* AC-Execution:  
 - Only with connection type: „D“, „K“, „B“, „L...-M47“, „M...-M28“  
 - 50 to 60 Hz  
 - Rectifier integrated in the plug plate  
 - Other nominal voltages and nominal power on request

*Appendix:*

Special lead execution (length 200 mm)	<input type="checkbox"/> M47
Special cable execution (length 1500 mm)	<input type="checkbox"/> M28

Design-Index (Subject to change)

**SPECIFICATIONS**

Coil winding insulation class	min. F (155° C)			
Protection class	depending on the connector version IP65 or IP67 according to EN 60 529 (if correctly mounted)	Nominal power (W)		
Relative duty factor	100% DF when mounted on armature tube and valve	(On/off function) (VA)		
Reference temperature	50 °C	Weight of solenoid coil (kg)		
		Voltage range (VDC) (VAC)		

	DC	AC		
	22			
		25		
	0,37			
	10-250			
		24-250		

	12 VDC	24 VDC	115 VAC	230 VAC
Nominal resistance (Ω)	7,2	25	420	1'500
Number of windings (-)	800	1'550	5'930	11'400
Inductivity (mH)	6	22	-	-
Nominal power (W)	11,3	11,7		
(Proportional function)				
Rated current (A)	1,25	0,68		
(Proportional function)				

**TYPE LISTE / DIMENSIONS / GENERAL SPECIFICATIONS**

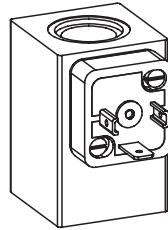
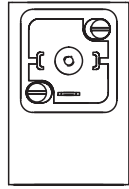
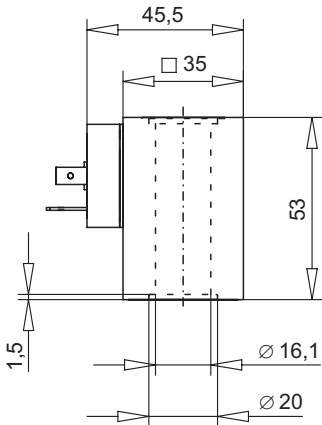

Execution: M **D** 35/16-...

- 3 contacts 2 P+E
- DC- and AC-execution available
- Connector socket plastic
- Protection class IP65

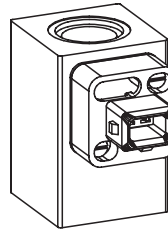
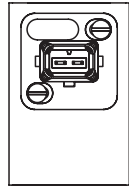
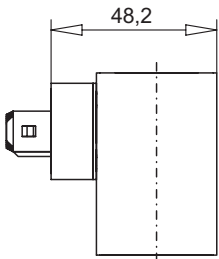

Execution: M **J** 35/16-...

- 2 contacts
- DC-execution available
- < 120 V external earth contact recommended
- > 120 V external earth contact necessary
- Connector socket plastic
- Protection class IP65

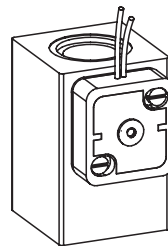
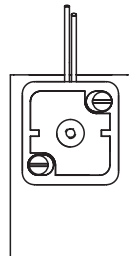
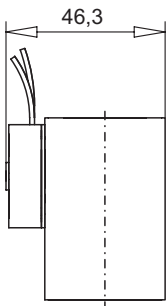

Execution: M **L** 35/16-...- **M47**

- 2 leads (2x 0,25 mm<sup>2</sup>) Radox 155
- Cable length 200 mm
- DC- and AC-execution available
- < 120 V external earth contact recommended
- > 120 V external earth contact necessary
- Leads housing plastic
- Protection class IP65

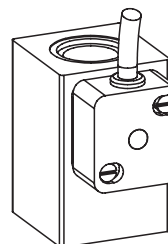
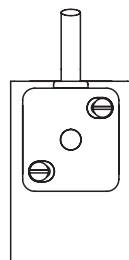
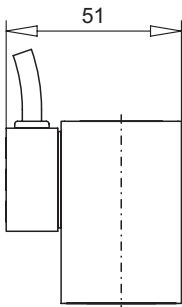

Execution: M **K** 35/16-...

- 3 conductors 3x 0,75 mm<sup>2</sup> Thermoplast
- Cable length 1500 mm
- Cable diameter 6 mm
- DC- and AC-execution available
- Cable housing plastic
- Protection class IP67

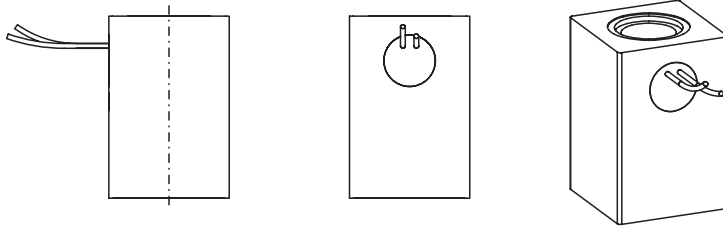

Execution: M **L** 35/16-...

- 2 leads (2x 0,25 mm<sup>2</sup>) Radox 155
- Cable length 500 mm
- DC-execution available
- < 120 V external earth contact recommended
- > 120 V external earth contact necessary
- Protection class IP65

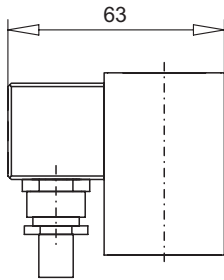

**DC-execution**

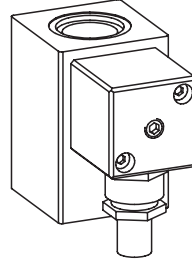
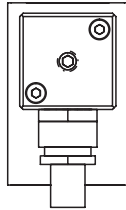

Execution: M **K** 35/16-...- **M28**

- 3 conductors 2x 1 mm<sup>2</sup> [+E] (acc. to IEC 332)
- Cable length 1500 mm
- DC- and AC-execution available
- Cable housing steel
- Protection class IP67

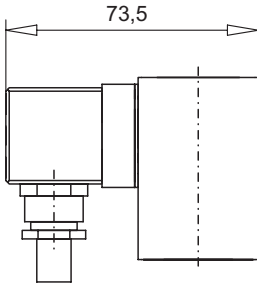

**AC-execution**

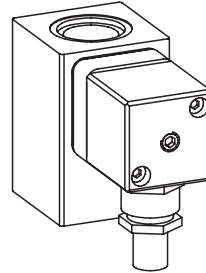
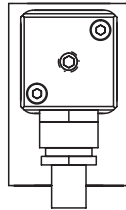

- Plastic rectifier housing

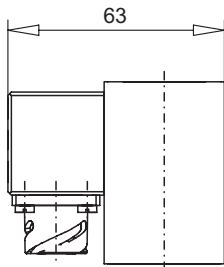

**DC-execution**

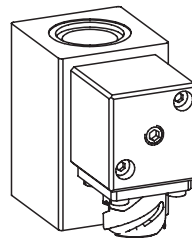
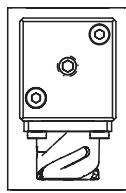

Execution: M **B** 35/16-...

- 3 contacts
- DC- and AC-execution available
- Connector housing steel
- Protection class IP67

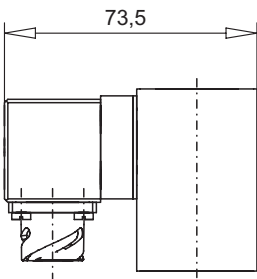

**AC-execution**

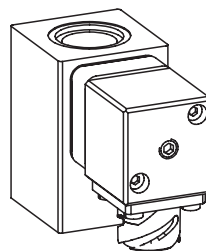
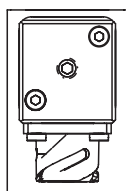

- Plastic rectifier housing

Neutral conductor Phase



Earthing conductor

**SAFE OPERATION**

**Caution:** To avoid overheating the coil may only be energised when mounted on an armature tube and valve.

Technical explanation see data sheet 1.1-400E