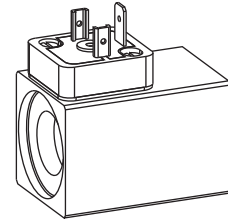

**Solenoid coil M.35/19x50
 according to VDE 0580
 Protection class IP65/IP67**

DESCRIPTION

The slip-on solenoid coil M.35/19x50 is available in different connection versions (see type code). The construction corresponds to the VDE 0580 standard. The steel housing is zinc coated as standard, with which a high degree of corrosion protection is guaranteed.

FUNCTION

With the combination of an armature tube the function of a switching solenoid or of a proportional solenoid results. With the AC executions the voltage is rectified. The available solenoid coils in AC execution are listed in the type code.

APPLICATION

Because of the robust design of the solenoid coils they are mainly utilised in hydraulic applications.

TYPE CODE

Metal housing, square	M	<input type="checkbox"/>	35 / 19x50	-	<input type="checkbox"/>	-	<input type="checkbox"/>	#	<input type="checkbox"/>
Connector version:									
Connector socket EN 175301-803/ISO 4400									
Connector socket AMP Junior-Timer									
Lead execution (length 500 mm)									
Cable execution (length 1500 mm)									
Bayonet connector									
Coil version									
Internal diameter 19 mm									
Length 50 mm									
Standard nominal voltage U_N									
	12 VDC								
	24 VDC								
	110 VAC								
	115 VAC								
	230 VAC								
* AC-Execution:									
– Only with connection version «D», «K», «B», «L...-M47», «M...-M28»									
– 50 to 60 Hz									
– Rectifier integrated in the connector socket									
– Other nominal voltages and nominal powers on request									
Additional designation:									
Special lead execution (length 200 mm)									
Special cable execution (length 1500 mm)									
Design-Index (Subject to change)									

SPECIFICATIONS

		12VDC	24VDC	115VAC	230VAC
Coil winding					
insulation class	min. H (180 °C)				
Relative duty factor	100% DF/ED combined with armature tube and valve				
Reference temperature	90 °C				
Nominal voltage range	10–250 VDC 24–250 VAC				
Nominal power (W)	(Switching function)	26	26	26	26
Limiting power (W)	(Proportional function)	16	16	–	–
Limiting current (A)	(Proportional function)	1,32	0,66	–	–
Nominal resistance (Ω)		5,6	22	410	1650
Number of windings (–)		718	1400	6 100	11 850
Weight of solenoid coil (kg)		0,32	0,32	0,32	0,32

SAFE OPERATION

Caution: Because of the danger of over-heating the solenoid coil must only be commissioned together with an armature tube as well as with a valve.

TYPE LISTE / DIMENSIONS / GENERAL SPECIFICATIONS

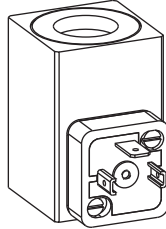
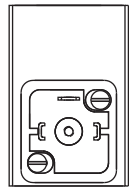
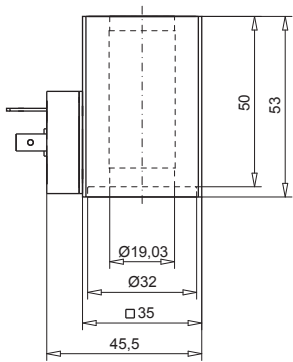

Execution: M **D** 35/19-...

- 3-poles 2 P+E
 - DC- and AC-execution available
 - Connector socket plastic
 - Protection class IP65
- With corresponding mating connector and professional assembly.

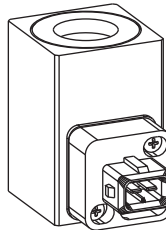
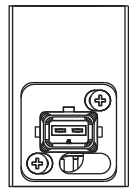
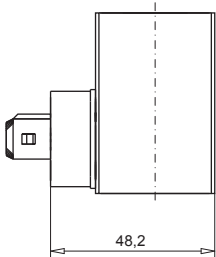

Execution: M **J** 35/19-...

- 2-poles
 - DC-execution available
 - < 120 V external grounding recommended
 - > 120 V external grounding necessary
 - Connector socket plastic
 - Protection class IP65
- With corresponding mating connector and professional assembly.

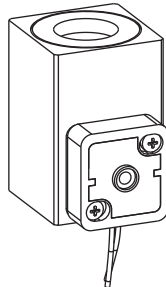
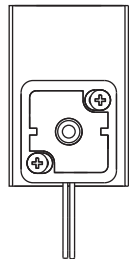
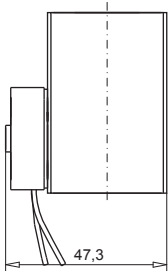

Execution: M **L** 35/19-...- **M47**

- 2-poles (2 x 0,25 mm²) Radox 155
 - Cable length 200 mm
 - DC- and AC-execution available
 - < 120 V external grounding recommended
 - > 120 V external grounding necessary
 - Leads housing plastic
 - Protection class IP65
- With professional assembly.

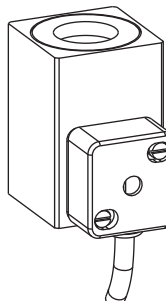
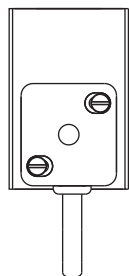
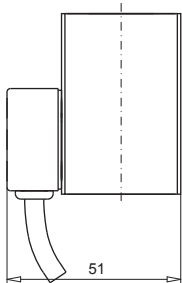

Execution: M **K** 35/19-...

- 3-poles 3 x 0,75 mm² Thermoplast
 - Cable length 1500 mm
 - Cable diameter 6 mm
 - DC- and AC-execution available
 - Cable housing plastic
 - Protection class IP67
- With professional assembly.

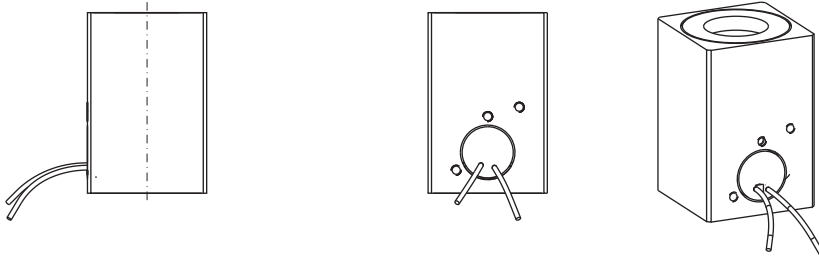

Execution: M **L** 35/19-...

- 2-poles (2x0,25 mm²) Radox 155
- Cable length 500 mm
- DC-execution available
- < 120 V external grounding recommended
- > 120 V external grounding necessary
- Protection class IP65
- With professional assembly.

DC-execution

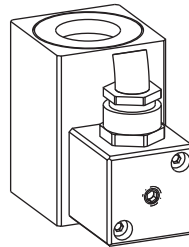
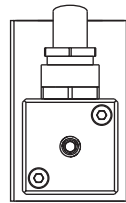
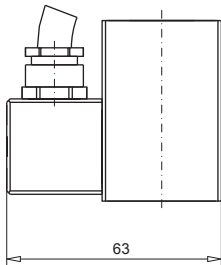

Execution: M **K** 35/19-...- **M28**

- 3-poles 2x1 mm² [E] (acc. to IEC 332)
- Cable length 1500 mm
- DC- and AC-execution available
- Cable housing made of steel
- Protection class IP67
- With professional assembly.

AC-execution

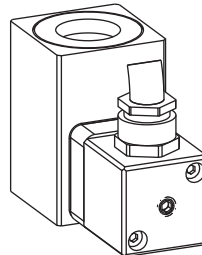
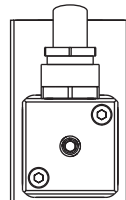
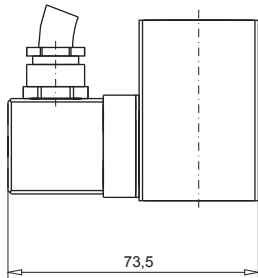

- Rectifier housing in plastic

DC-execution

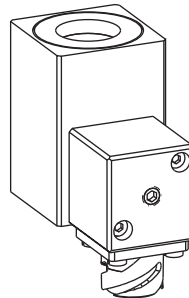
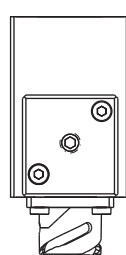
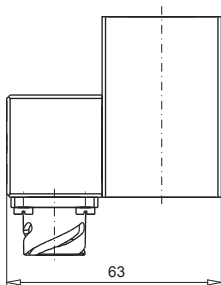

Execution: M **B** 35/19-...

- 3-poles
- DC- and AC-execution available
- Connector housing made of steel
- Protection class IP67
- With corresponding mating connector and professional assembly.

Neutral conductor



Earth conductor

AC-execution

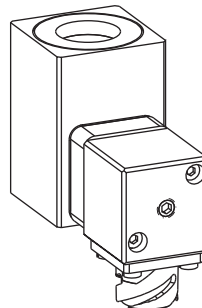
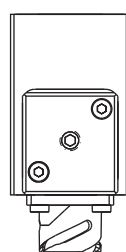
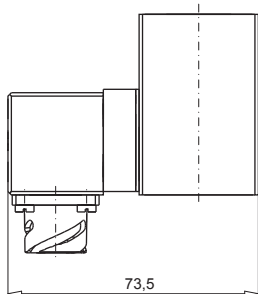

- Rectifier housing in plastic

SAFE OPERATION

Caution: Because of the danger of over-heating the solenoid coil must only be commissioned together with an armature tube as well as with a valve.

Technical explanation see data sheet 1.1-400 and 1.1-410