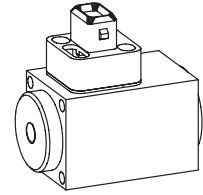

**Solenoids with special electric connection**

**LIST OF TYPES OF CONNECTIONS**

Standard solenoid Data sheet no.		Special types of connection / Dimensions <b>H</b> in mm (inclusive standard solenoid)								
		Standard DIN-connector	<b>M92</b> AMP-Junior-Timer	<b>M47</b> Flying leads with socket	<b>M56</b> Cable with socket	<b>M55</b> Flying leads without socket	<b>M28</b> Cable with connector VDC	<b>M28</b> Cable with connector VAC	<b>M34</b> Bayonet connector VDC	<b>M34</b> Bayonet connector VAC
SIN29V	1.1-80									
SIS29V	1.1-85	39,5	42,2	40,3	45	29	57	67,5	57	67,5
PI29V	1.1-90									
BEIIV	1.1-100									
SIN35V	1.1-105	45,5	48,2	46,3	51	35	63	73,5	63	73,5
SIS35V	1.1-110									
PI35V	1.1-115									
SIN45V	1.1-120									
SIS45V	1.1-125	55,5	58,2	56,3	61	45	73	83,5	73	83,5
PI45V	1.1-130									
SIN60V	1.1-145									
SIS60V	1.1-150	70,5	73,2	71,3	76	60	88	98,5	88	98,5
PI60V	1.1-155									

**ORDERING EXAMPLE FOR SOLENOID**

SI S 35 V -  -  #

Solenoid  
Industry version

Super

Square 35 mm housing

Solenoid completely potted

Standard nominal voltage  $U_N$ :

12 VDC	<input type="text" value="G12"/>
24 VDC	<input type="text" value="G24"/>
110 VAC	<input type="text" value="R110"/> *
115 VAC	<input type="text" value="R115"/> *
230 VAC	<input type="text" value="R230"/> *

AC= 50 to 60 Hz  
\* Rectifier integrated in the plug  
Other nominal voltages and nominal power on request

Code for special type of connection

Design-Index (Subject to change)

**ORDERING EXAMPLE FOR VALVE**

 WDSFA06 - ABC - G24 - 
**REMARK!**

Manual override resp. plug are not included in scope of supply. They have to be ordered separately (see data sheet 1.1-300 and 1.1-310).

**TYPE LISTE / DIMENSIONS / GENERAL SPECIFICATIONS**

Standard type with DIN-connector

Example: SIS35V-G24

- 3 contacts 2 P+E
- DC- and AC-execution available
- Connector socket plastic
- Protection class IP65

Execution: **M92**

with AMP Junior-Timer connector

Example: SIS35V-G24-M92

- 2 contacts
- DC-execution available
- < 120 V external earth contact recommended
- > 120 V external earth contact necessary
- Connector socket plastic
- Protection class IP65

Execution: **M47** with flying leads

Example: SIS35V-G24-M47

- 2 leads (2x 0,25 mm<sup>2</sup>) Radox 155
- Cable length 200 mm
- DC- and AC-execution available
- < 120 V external earth contact recommended
- > 120 V external earth contact necessary
- Leads housing plastic
- Protection class IP65

Execution: **M56** with cable

Example: SIS35V-G24-M56

- 3 conductors 3x 0,75 mm<sup>2</sup> Thermoplast
- Cable length 1500 mm
- Cable diameter 6 mm
- DC- and AC-execution available
- Cable housing plastic
- Protection class IP67

Execution: **M55** with flying leads

Example: SIS35V-G24-M55

- 2 leads (2x 0,25 mm<sup>2</sup>) Radox 155
- Cable length 500 mm
- DC-execution available
- < 120 V external earth contact recommended
- > 120 V external earth contact necessary
- Protection class IP65

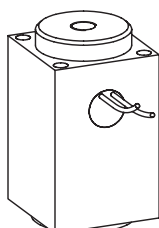
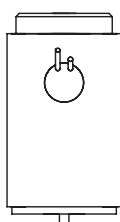
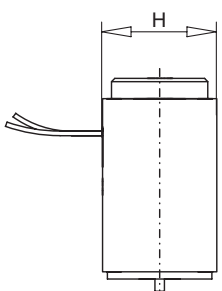
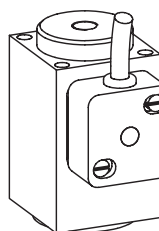
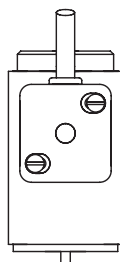
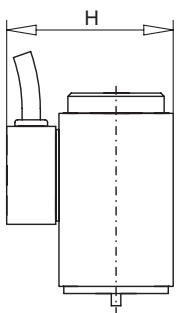
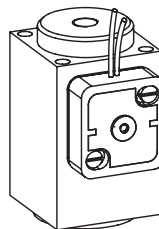
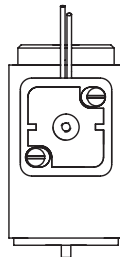
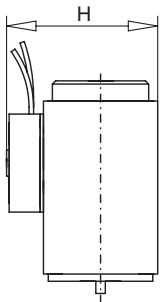
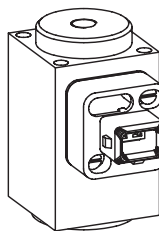
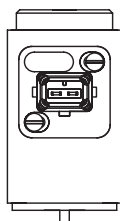
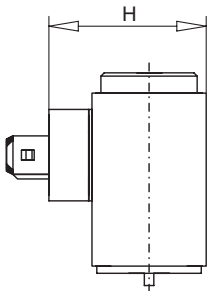
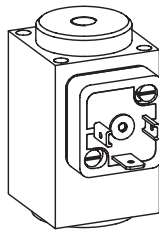
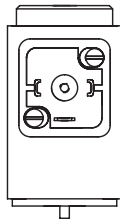
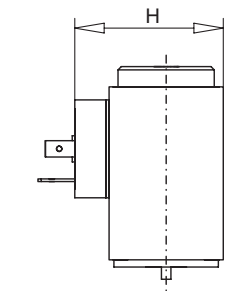

**TYPE LISTE / DIMENSIONS / GENERAL SPECIFICATIONS**

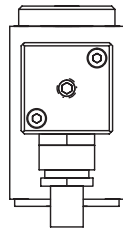
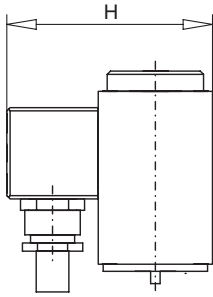

**DC-execution**

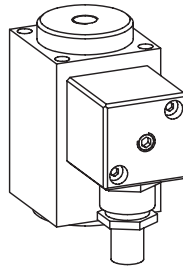

Execution: **M28** with cable  
Example: SIS35V-G24-M28

- 3 conductors 2x 1 mm<sup>2</sup> [+E] (acc. to IEC 332)
- Cable length 1500 mm
- DC- and AC-execution available
- Cable housing steel
- Protection class IP67

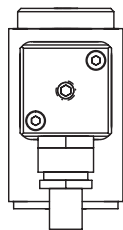
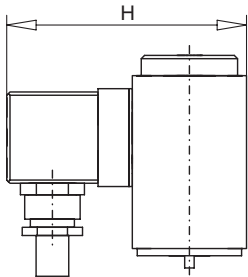

**AC-execution**

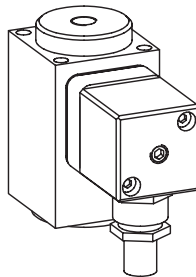

• Plastic rectifier housing  
Example: SIS35V-R230-M28

- Plastic rectifier housing

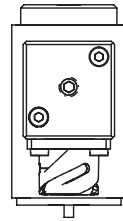
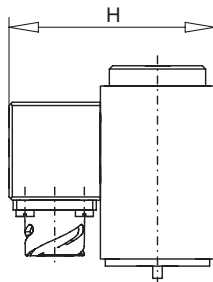

**DC-execution**

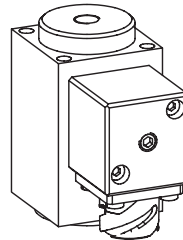

Execution: **M34** with bayonet connector  
Example: SIS35V-G24-M34

- 3 contacts
- DC- and AC-execution available
- Connector housing steel
- Protection class IP67

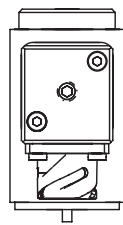
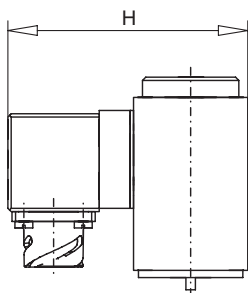

**AC-execution**

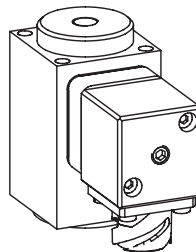

• Plastic rectifier housing  
Example: SIS35V-R230-M34

- Plastic rectifier housing

Neutral conductor Phase



Earthing conductor

**SAFE OPERATION**

**Caution:** To avoid overheating the solenoid may only be energised when mounted on an armature tube and valve.

**REMARK!**

For additional information and performance data refer to the corresponding data sheet of the standard solenoid.

Technical explanation see data sheet 1.1-400E